



ASHFORD INTERNATIONAL



THE QHOTELS COLLECTION

# CAPACITIES

Meeting Room	Dimensions (m) L x W x H	Floor	Theatre	Cabaret	Classroom	Boardroom	Banquet	U-Shape	Dinner Dance
The Kent Suite	22.2 x 17.6 x 3.7	G	400	250	150	n/a	300	n/a	300
Canterbury Suite	25.5 x 9.0 x 3.7	G	200	120	100	n/a	150	n/a	150
Maidstone	17.6 x 11.1 x 3.7	G	200	120	80	n/a	120	n/a	120
Tonbridge	17.6 x 11.1 x 3.7	G	200	120	80	n/a	120	n/a	120
Courtyard	10.6 x 9.4 x 2.2	G	80	50	30	30	50	30	n/a
Garden	10.6 x 9.4 x 2.2	G	80	50	30	30	50	30	n/a
Whitstable	8.5 x 9.0 x 3.7	G	70	50	30	30	50	24	n/a
Faversham	8.5 x 9.0 x 3.7	G	70	50	30	30	50	24	n/a
Tankerton	8.5 x 9.0 x 3.7	G	60	50	30	30	50	24	n/a
Chartwell	7.9 x 7.2 x 2.1	1	40	30	20	26	n/a	20	n/a
Boardroom 1	10.3 x 7.2 x 2.2	1	n/a	n/a	n/a	12	n/a	n/a	n/a
Willesborough	9.4 x 5.6 x 2.6	G	50	24	20	24	24	n/a	n/a
Romney	7.9 x 7.2 x 2.1	1	40	30	20	26	n/a	20	n/a
Charing	9.4 x 4.7 x 2.6	G	50	24	20	24	24	n/a	n/a
Kennington	7.9 x 3.4 x 2.1	1	20	n/a	n/a	14	n/a	n/a	n/a
Mersham	7.9 x 3.4 x 2.1	1	20	n/a	n/a	14	n/a	n/a	n/a
Sissinghurst	5.5 x 4.4 x 2.1	1	n/a	n/a	n/a	6	n/a	n/a	n/a
Appledore	4.6 x 3.5 x 2.1	1	n/a	n/a	n/a	6	n/a	n/a	n/a
Boardroom 2	10.3 x 7.2 x 2.2	2	n/a	n/a	n/a	14	n/a	n/a	n/a



**ASHFORD INTERNATIONAL**

THE QHOTELS COLLECTION

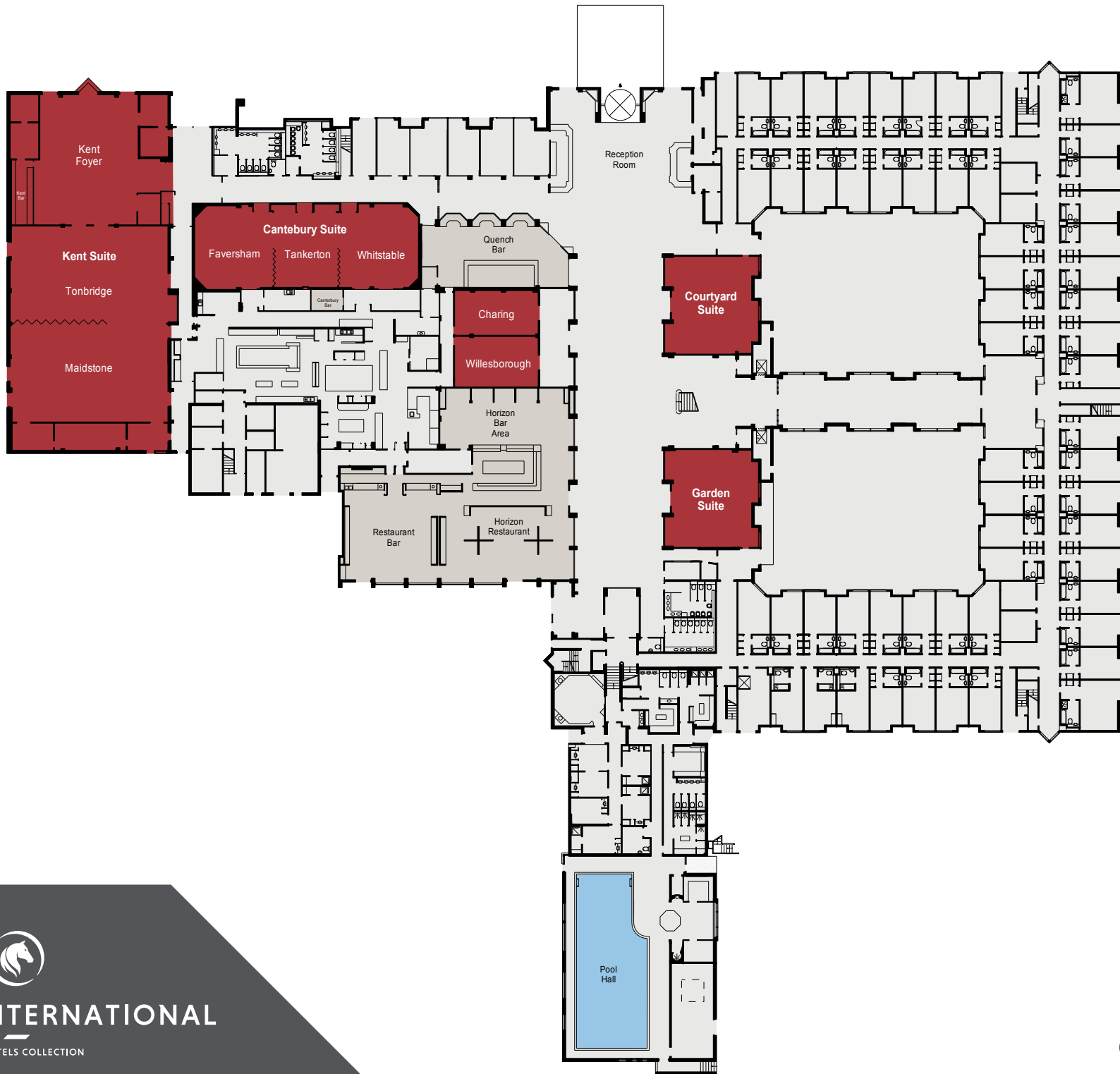

ASHFORD INTERNATIONAL

THE QHOTELS COLLECTION

GROUND FLOOR

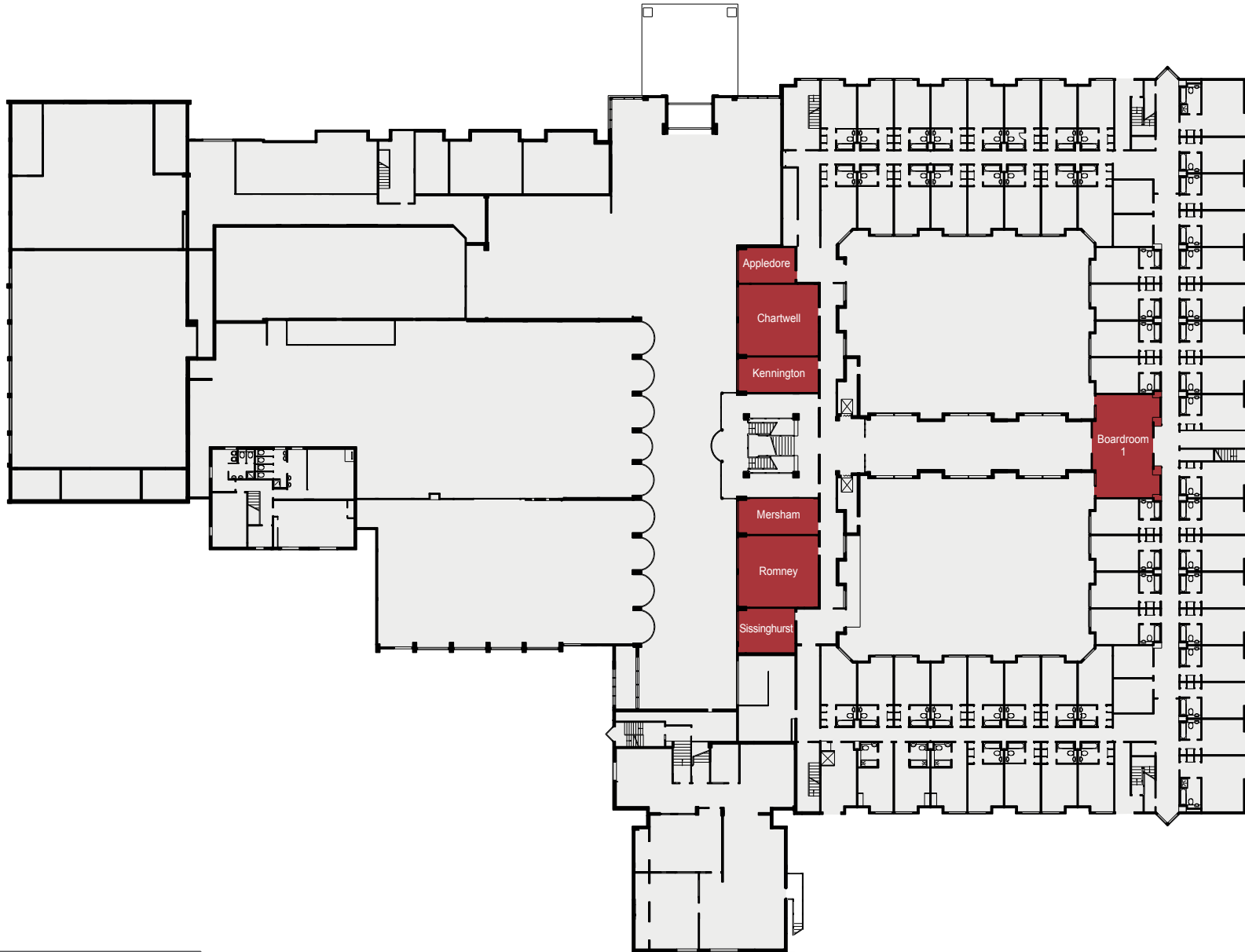

ASHFORD INTERNATIONAL

THE QHOTELS COLLECTION

FIRST FLOOR

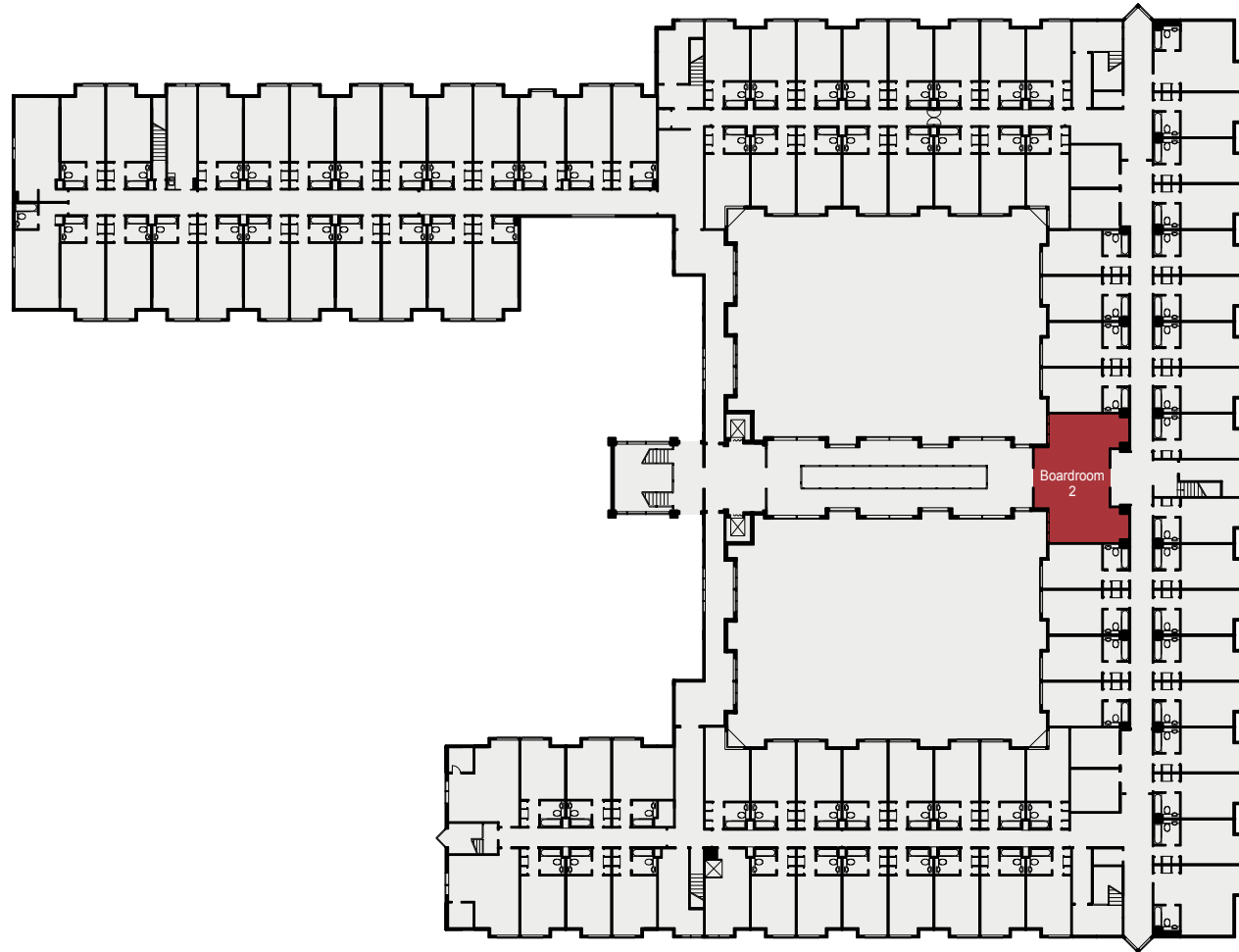

ASHFORD INTERNATIONAL

THE QHOTELS COLLECTION

SECOND FLOOR

# KEY

- Single 13amp Power Point
- Double 13amp Power Point
- ▶ Natural Light
- ☎ Telephone Socket
- \* Hanging Points
- ♿ Wheelchair Access
- Pillars
- ⚡ Partition Wall

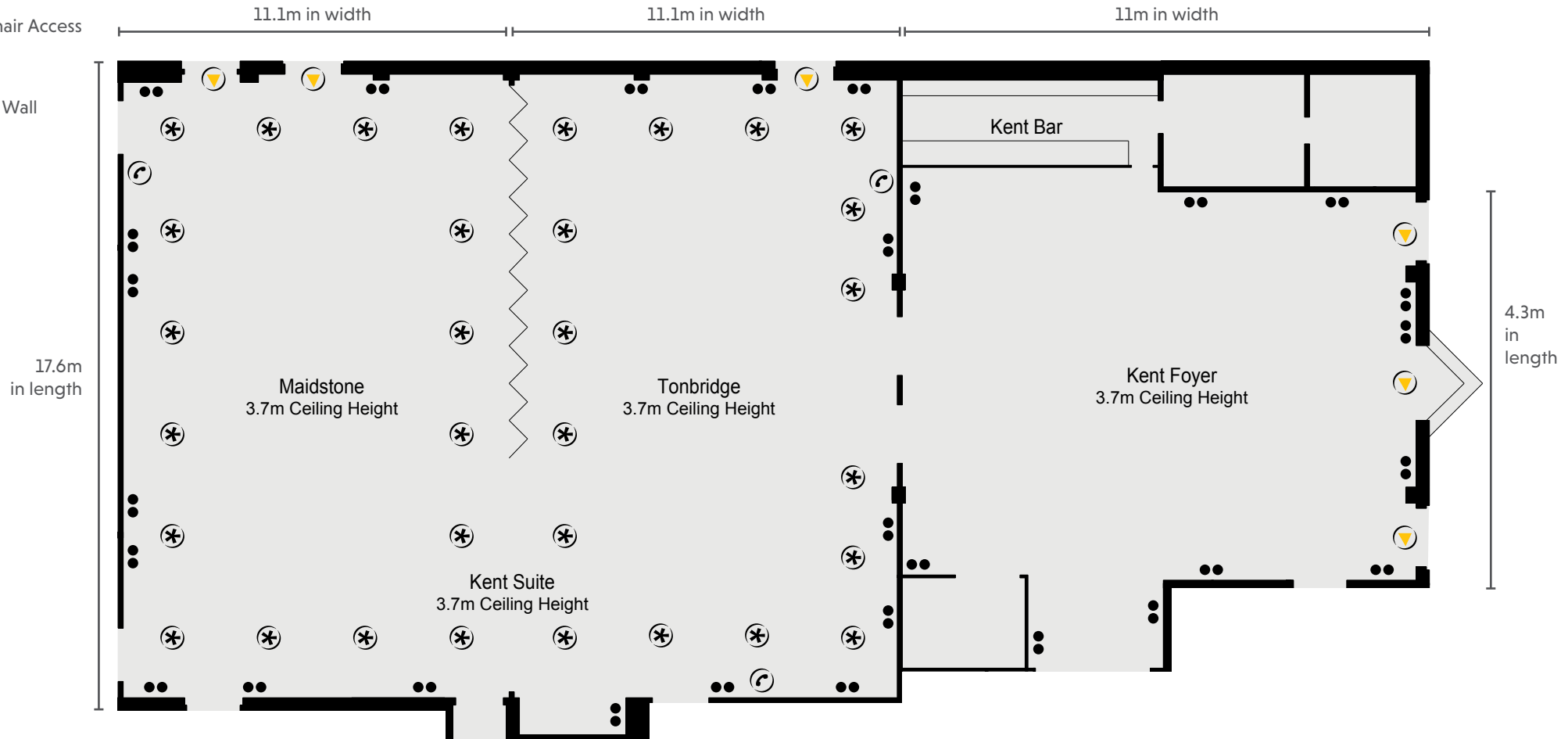

ASHFORD INTERNATIONAL

THE QHOTELS COLLECTION

GROUND FLOOR

## KEY

- Single 13amp Power Point
- Double 13amp Power Point
- ▶ Natural Light
- ☎ Telephone Socket
- ✱ Hanging Points
- ♿ Wheelchair Access
- Pillars
- ⋈ Partition Wall

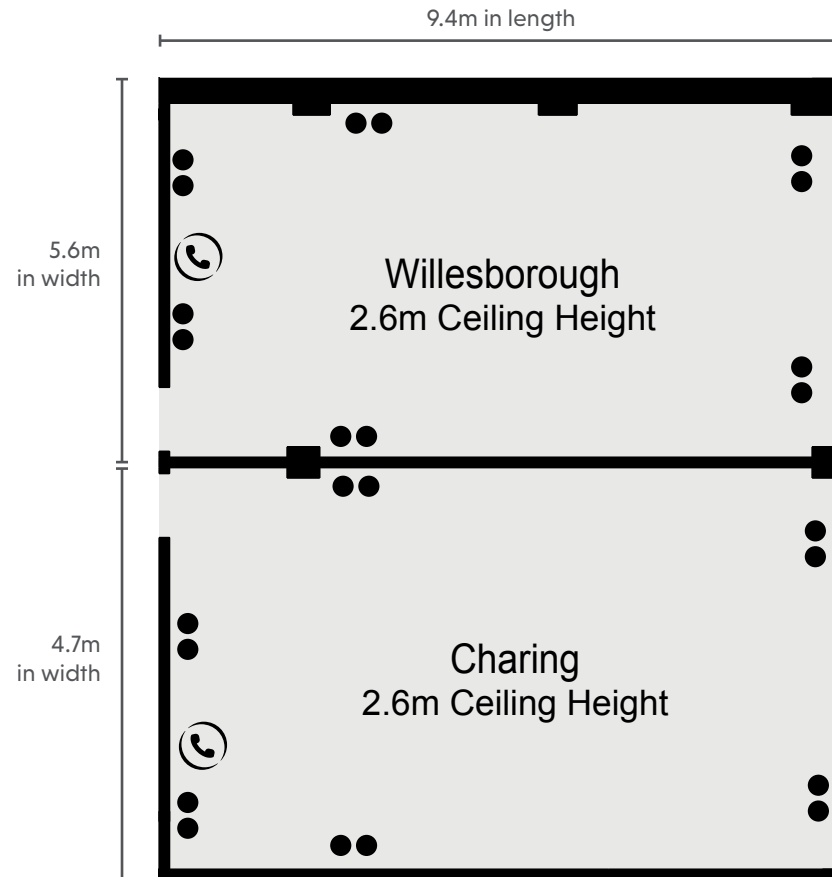

ASHFORD INTERNATIONAL

THE QHOTELS COLLECTION

GROUND FLOOR

**KEY**

- Single 13amp Power Point
- Double 13amp Power Point
- ▶ Natural Light
- ☎ Telephone Socket
- \* Hanging Points
- ♿ Wheelchair Access
- Pillars
- ⚡ Partition Wall

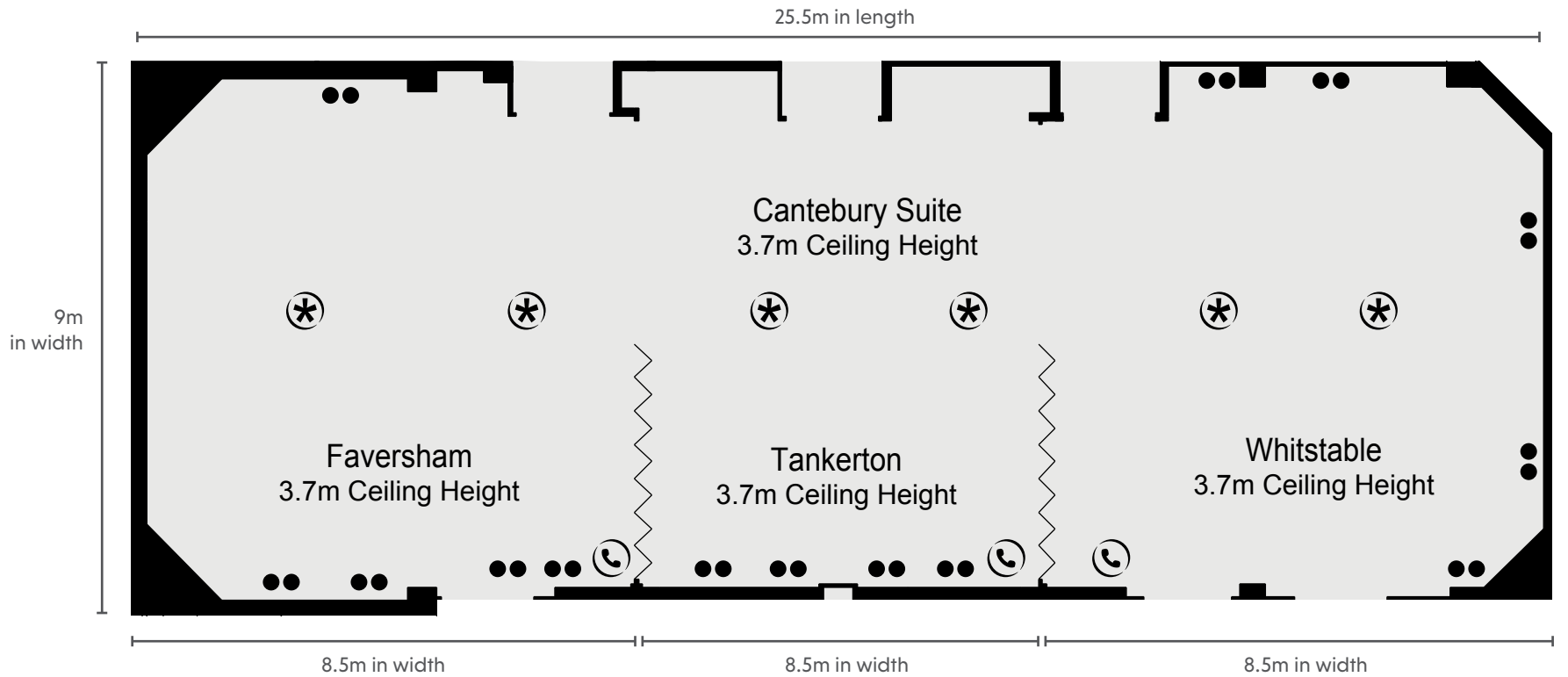

**ASHFORD INTERNATIONAL**

THE QHOTELS COLLECTION

GROUND FLOOR



**KEY**

- Single 13amp Power Point
- Double 13amp Power Point
- ▶ Natural Light
- ☎ Telephone Socket
- \* Hanging Points
- ♿ Wheelchair Access
- Pillars
- ⋈ Partition Wall

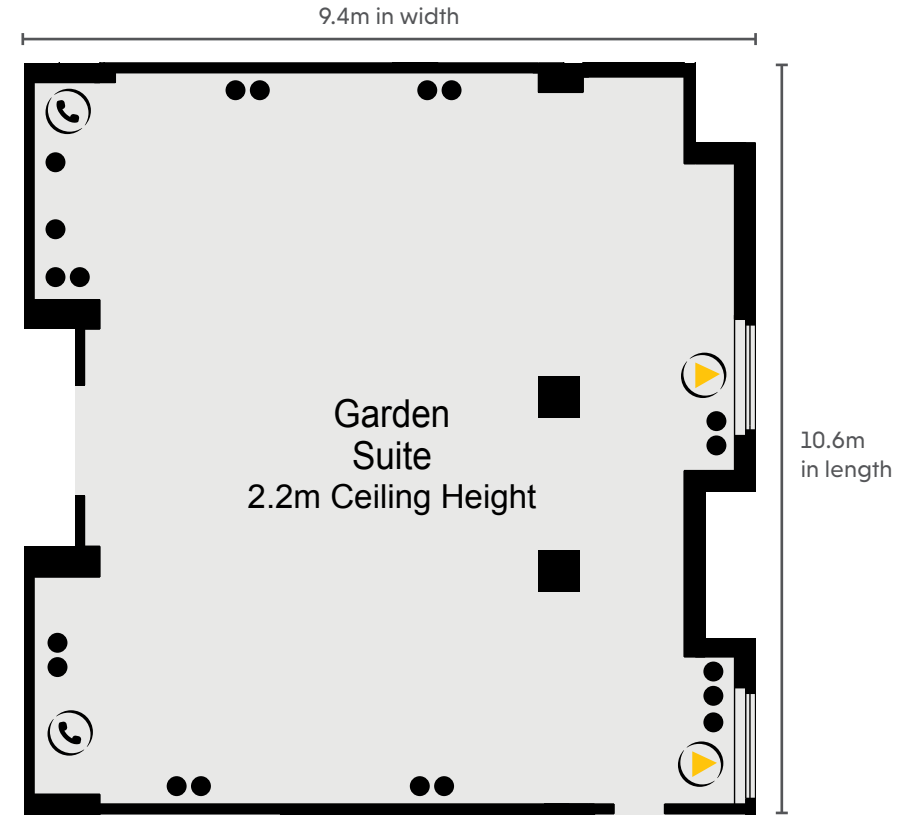
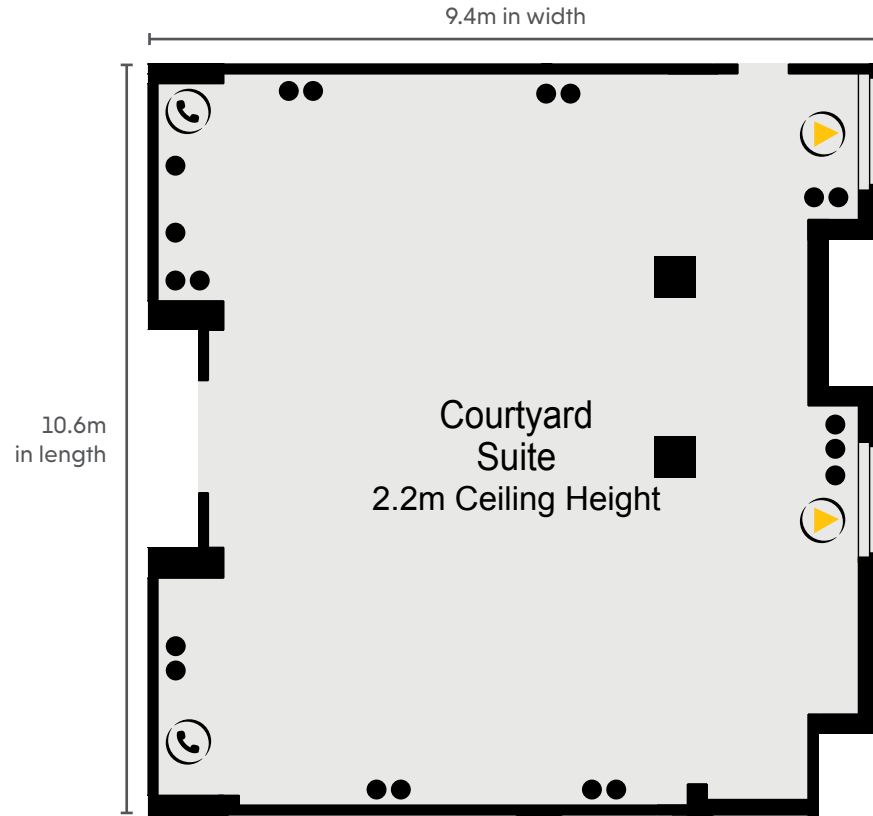

**ASHFORD INTERNATIONAL**

THE QHOTELS COLLECTION

GROUND FLOOR

## KEY

- Single 13amp Power Point
- Double 13amp Power Point
- ▶ Natural Light
- ☎ Telephone Socket
- \* Hanging Points
- ♿ Wheelchair Access
- Pillars
- ⋈ Partition Wall

\*The windows overlook the lobby which has natural daylight

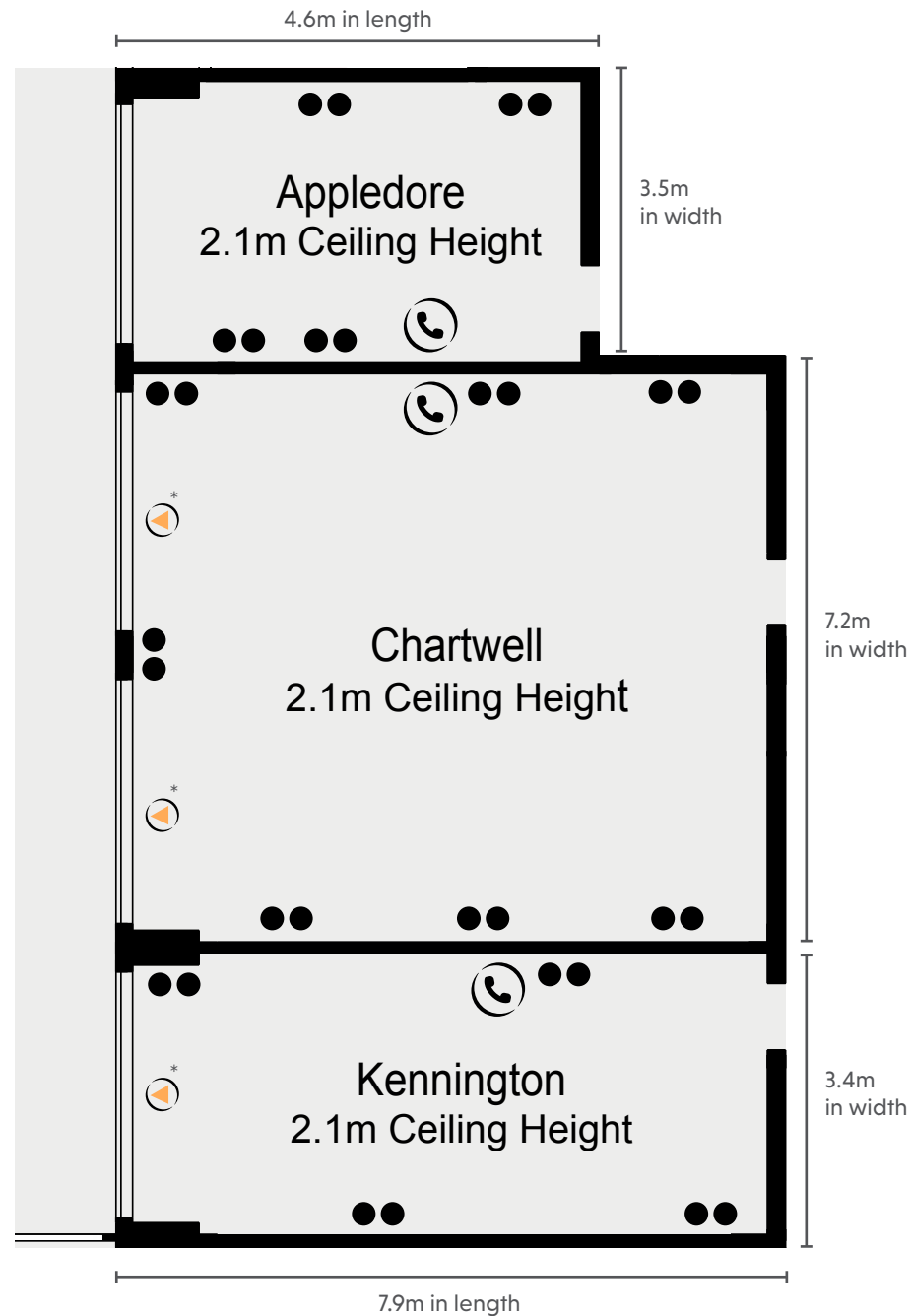

ASHFORD INTERNATIONAL

THE QHOTELS COLLECTION

FIRST FLOOR

# KEY

- Single 13amp Power Point
- Double 13amp Power Point
- ▶ Natural Light
- ☎ Telephone Socket
- ✳ Hanging Points
- ♿ Wheelchair Access
- Pillars
- ⋈ Partition Wall

\*The windows overlook the lobby which has natural daylight

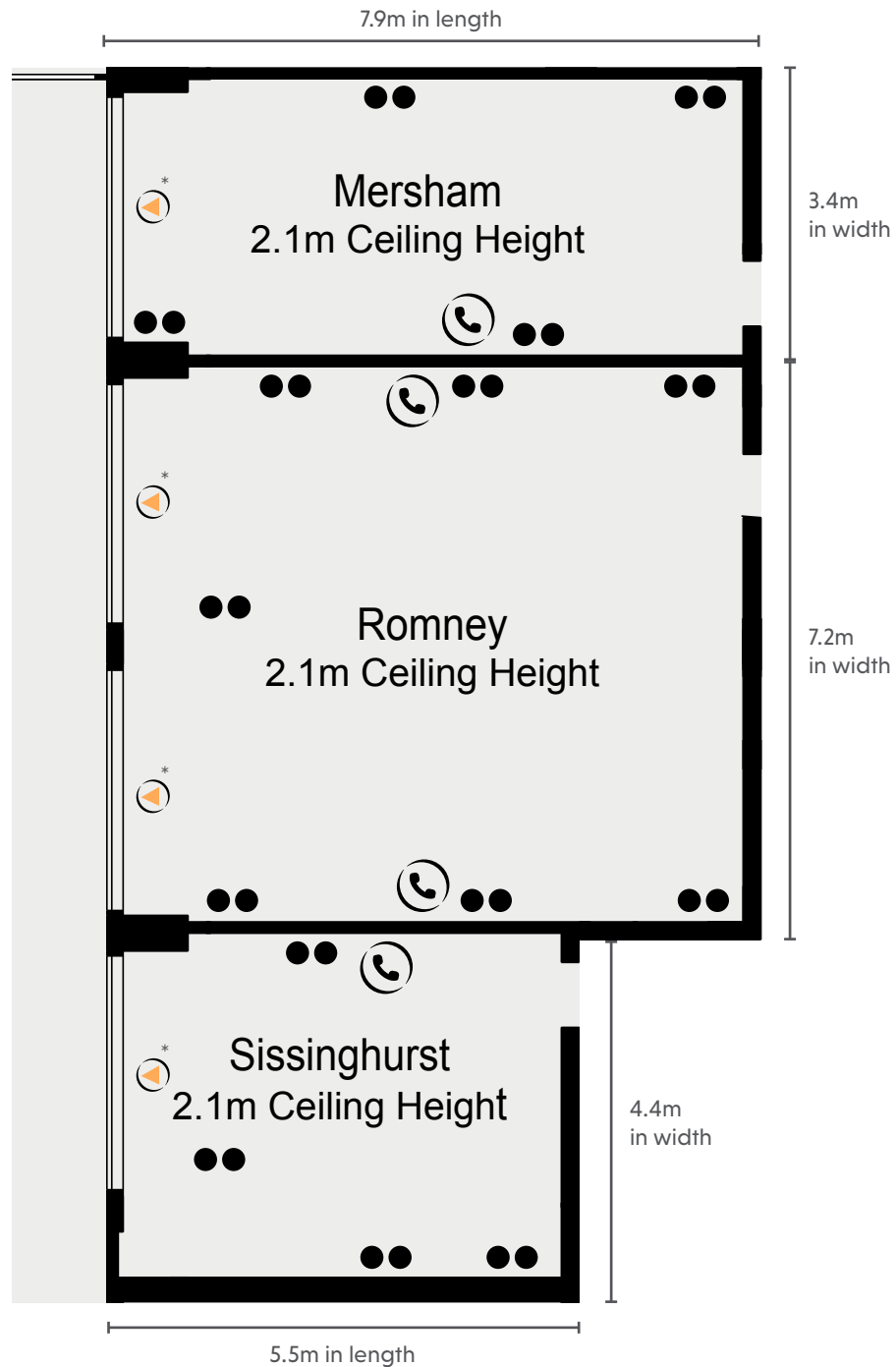

## KEY

- Single 13amp Power Point
- Double 13amp Power Point
- ▶ Natural Light
- ☎ Telephone Socket
- \* Hanging Points
- ♿ Wheelchair Access
- Pillars
- ⋈ Partition Wall

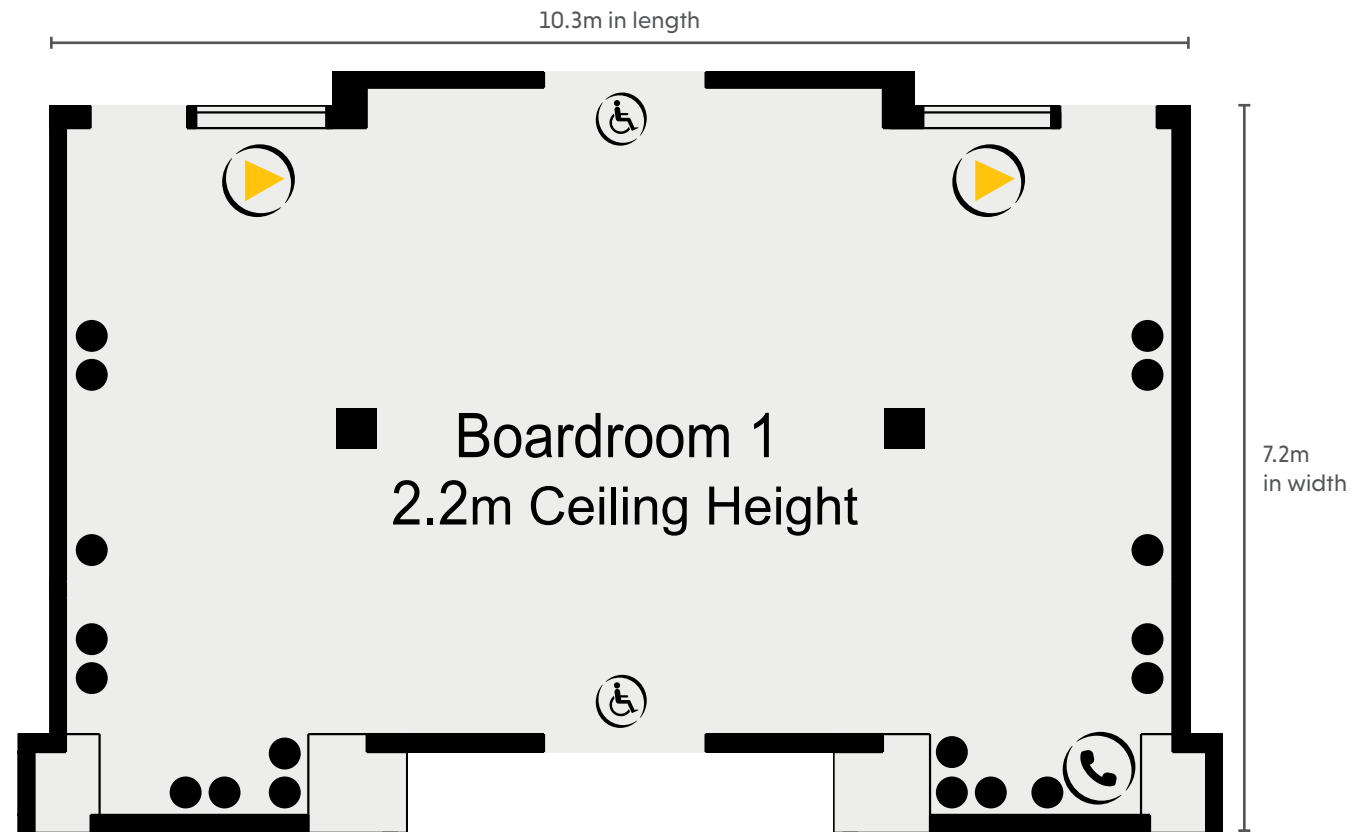

ASHFORD INTERNATIONAL

THE QHOTELS COLLECTION

FIRST FLOOR

## KEY

- Single 13amp Power Point
- Double 13amp Power Point
- ▶ Natural Light
- ☎ Telephone Socket
- \* Hanging Points
- ♿ Wheelchair Access
- Pillars
- ⋈ Partition Wall

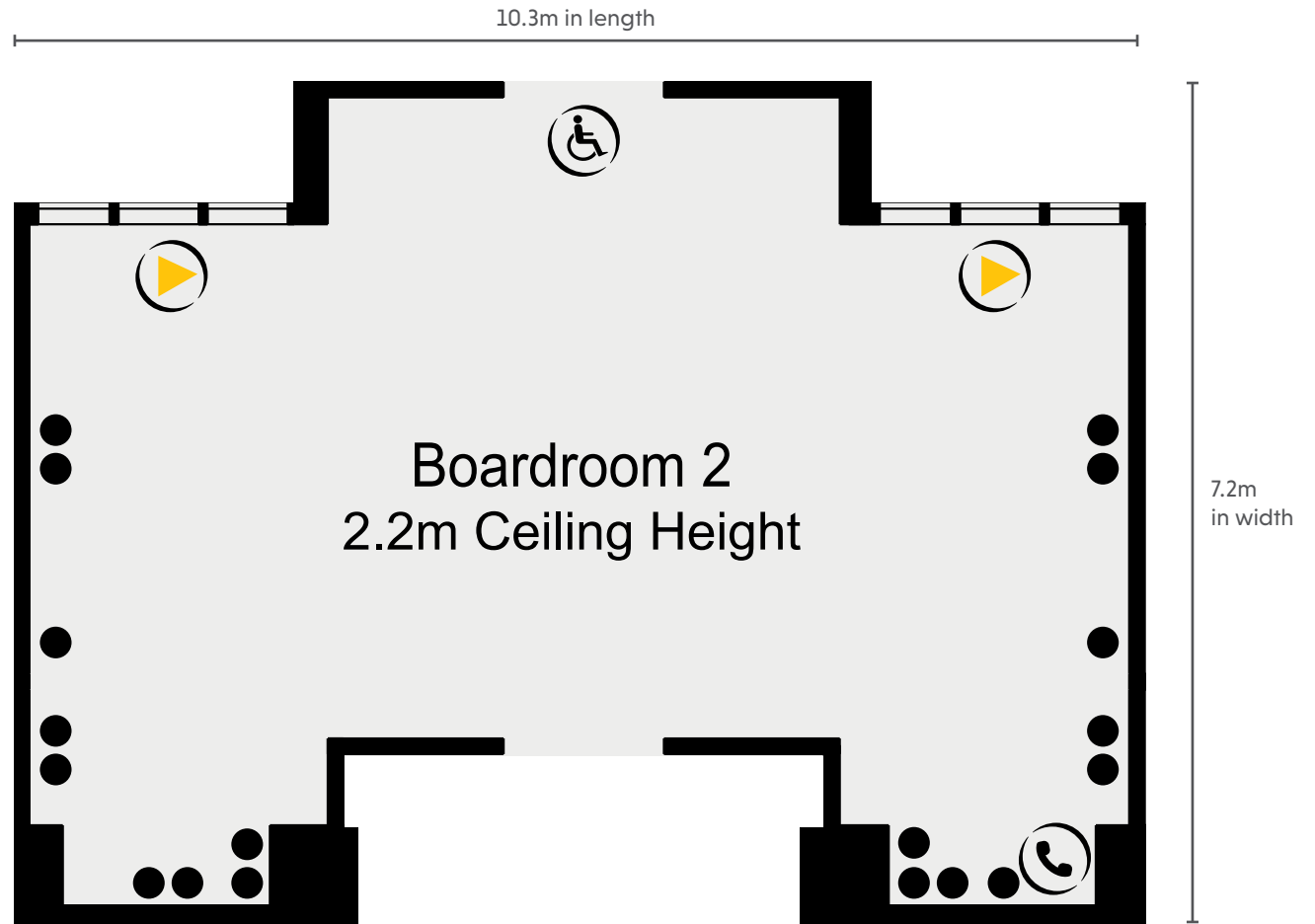

ASHFORD INTERNATIONAL

THE QHOTELS COLLECTION

SECOND FLOOR